

REVISIONS			
REV.	DESCRIPTION	DATE	APPROVED
A	DRAWN IN SW	5/27/2014	JJH

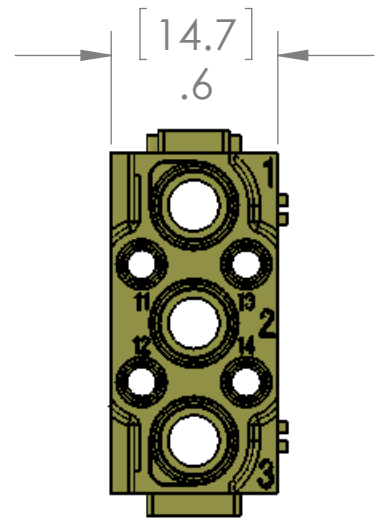
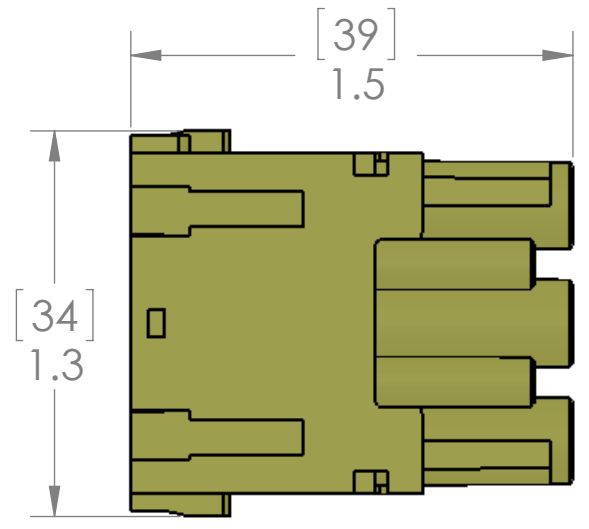
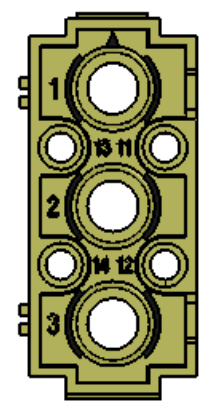
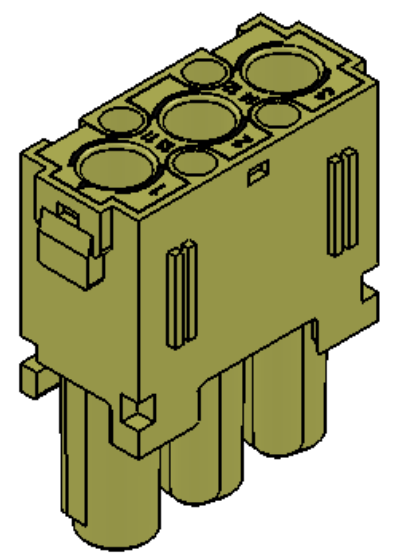

MATERIALS AND SPECIFICATIONS	
HOUSING:	THERMOPLASTIC RESIN UL 94 V0
TEMPERATURE:	-40°C to +125°C
RATINGS:	
3 POLES:	EN 830V/8kV/3, 40A
4 POLES:	EN 830V/8kV/3, 10A
UL/CSA:	600V

**PROPRIETARY AND CONFIDENTIAL**  
 THE INFORMATION CONTAINED IN THIS DRAWING IS THE SOLE PROPERTY OF MENCOM CORPORATION. ANY REPRODUCTION IN PART OR AS A WHOLE WITHOUT THE WRITTEN PERMISSION OF MENCOM CORPORATION IS PROHIBITED.

UNLESS OTHERWISE SPECIFIED:		NAME
DIMENSIONS ARE IN INCHES AND [MM]	DRAWN	RSC
	CHECKED	
	ENG APPR.	
	MFG APPR.	
	Q.A.	
MATERIAL	COMMENTS:	
FINISH		
DO NOT SCALE DRAWING		

MENCOM CORPORATION		
TITLE:		
MIXO FEMALE INSERT		
SIZE	DWG. NO.	REV
<b>B</b>	CX-34XDF	<b>A</b>
SCALE: 3:2	WEIGHT:	SHEET 1 OF 1