

CR anchorages

inserts

MIXO series

from page 262

shield earthing anchorage for shielded cables
(for MIXO series)
clamps for cables w/shield \varnothing 5 mm and
 \varnothing 10 mm



anchorages for several PE connection
cables (for MIXO series)

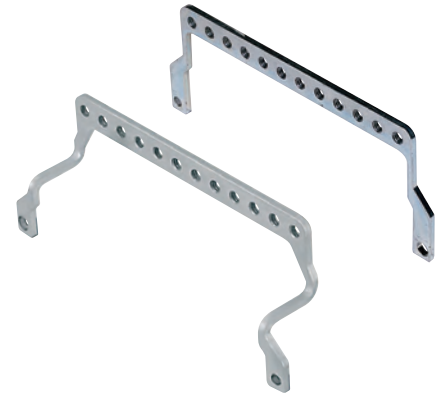

description

part No.

part No.

in zinc plated steel, to be mounted on MIXO frames
in bulkhead mounting housings, COB series enclosures
and high construction hoods with top entry
enclosures "44.27" and MIXO frames for 2 modular units
enclosures "57.27" and MIXO frames for 3 modular units *
enclosures "77.27", "77.62" and MIXO frames for 4 modular units
enclosures "104.27", "104.62" and MIXO frames for 6 modular units

CR 06 ST
CR 10 ST
CR 16 ST
CR 24 ST

to be mounted on CR..ST earthing terminals
clamp for shielding cables \varnothing 5 mm
clamp for shielding cables \varnothing 10 mm

CR 05 CA
CR 10 CA

in zinc plated steel, to be mounted on MIXO frames
in bulkhead mounting housings, COB series enclosures
and high construction hoods with top entry
enclosures "44.27" and MIXO frames for 2 modular units
enclosures "57.27" and MIXO frames for 3 modular units
enclosures "77.27", "77.62" and MIXO frames for 4 modular units
enclosures "104.27", "104.62" and MIXO frames for 6 modular units
enclosures "104.27", "104.62" and MIXO frames for 6 modular units

CR 06 AT
CR 10 AT
CR 16 AT
CR 24 AT
CR 24 ATD

* Fixed using the standard screws of the MIXO frame,
the draw size are supplied with a special M4 screw
that replaces the standard one.

Anchorage CR .. ST are designed for installation
on the frames of the MIXO modular connectors, for earth
connecting the screening braid of shielded cables.

Anchorage CR .. AT / ATD are designed for installation
on the frames of the MIXO modular connectors for earth
connecting several cables.

CR...ST

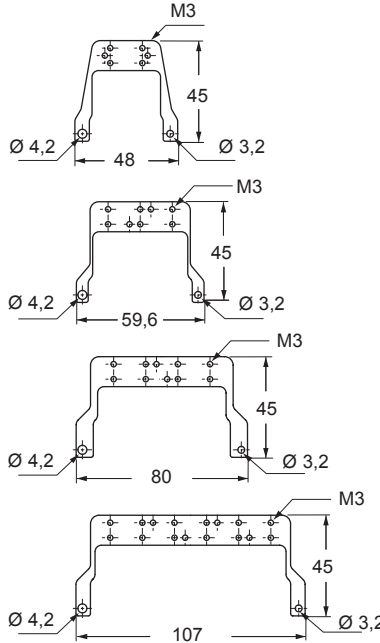

CR...CA

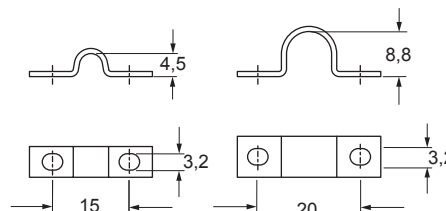

CR...AT

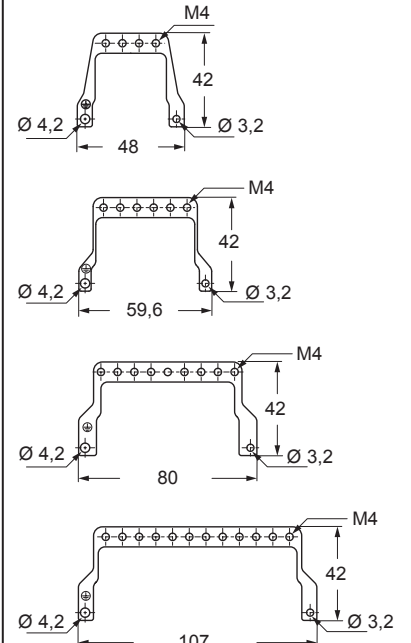

CR 24 ATD

