

# CH and MH C-TYPE standard version

inserts		page:
CD	80 poles + ⊕	73
CDD	144 poles + ⊕	82
CDS	54 poles + ⊕	-
CDSH	54 poles + ⊕	90
CNE	32 poles + ⊕	114
CSE	32 poles + ⊕	-
CSH	32 poles + ⊕	114
CSH S	32 poles + ⊕	126
CCE	32 poles + ⊕	134
CSS	32 poles + ⊕	152
CQE	64 poles + ⊕	172
CME	12+4 (aux) poles + ⊕	142
CMSH	12+4 (aux) poles + ⊕	142
CMCE	12+4 (aux) poles + ⊕	143
CP	12 poles + ⊕	179
MIXO	4 + 4 modules	262 - 317

insert dimensions:  
2 x (77,5 x 27) mm

## surface mounting housings with 2 levers



## surface mounting housings with single lever



description	part No.	entry Pg	part No.	entry M	part No.	entry Pg	part No.	entry M
with one or two levers	<b>CHP 32.29</b>	29	<b>MHP 32.40</b>	40	<b>CHP 32 L29</b>	29	<b>MHP 32 L40</b>	40
with one or two levers	<b>CHP 32.229</b>	29 x 2	<b>MHP 32.240</b>	40 x 2	<b>CHP 32 L229</b>	29 x 2	<b>MHP 32 L240</b>	40 x 2
with one or two levers	<b>CHP 32</b>	36	<b>MHP 32.50</b>	50	<b>CHP 32 L</b>	36	<b>MHP 32 L50</b>	50
with one or two levers	<b>CHP 32.2</b>	36 x 2	<b>MHP 32.250</b>	50 x 2	<b>CHP 32 L2</b>	36 x 2	<b>MHP 32 L250</b>	50 x 2
with one or two levers	<b>CHP 32.42</b>	42			<b>CHP 32 L42</b>	42		
with one or two levers	<b>CHP 32.242</b>	42 x 2			<b>CHP 32 L242</b>	42 x 2		
with lever and aluminium cover					<b>CHP 32 LS29</b>	29	<b>MHP 32 LS40</b>	40
with lever and aluminium cover					<b>CHP 32 LS229</b>	29 x 2	<b>MHP 32 LS240</b>	40 x 2
with lever and aluminium cover					<b>CHP 32 LS</b>	36	<b>MHP 32 LS50</b>	50
with lever and aluminium cover					<b>CHP 32 LS2</b>	36 x 2	<b>MHP 32 LS250</b>	50 x 2
with lever and aluminium cover					<b>CHP 32 LS42</b>	42		
with lever and aluminium cover					<b>CHP 32 LS242</b>	42 x 2		

**Q IMPORTANT NOTE:** The enclosures ensure IP66/IP69 degree of protection (or IP65 for hinged cover versions) when mated and locked with the closing levers. The cover (CS, CP) only ensures mechanical protection, but does not ensure IP65 degree of protection.

### CHP and MHP ▲

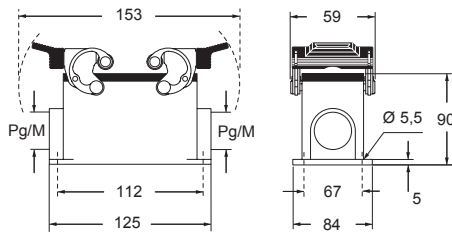

### CHP L and MHP L ▲

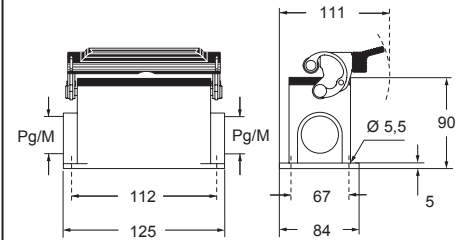

### CHP LS and MHP LS ●

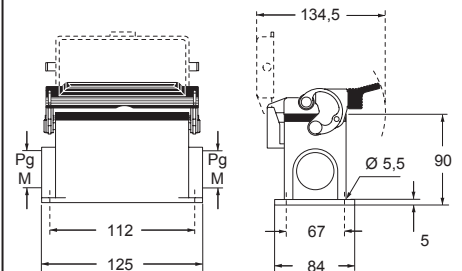

**CAIUS** Type 4/4X/12

- IP65 insulating cable gland or fittings without gasket
- ▲ IP66 IP69 cable gland with O-Ring gasket