

CH - CA - CF and MH - MA - MF C-TYPE standard version

inserts		page:
CDD	24 poles + ⊕	76
CDS	9 poles + ⊕	-
CDSH	9 poles + ⊕	86
CDSH NC	6 poles + ⊕	95
CNE	6 poles + ⊕	110
CSE	6 poles + ⊕	-
CSH	6 poles + ⊕	110
CSH S	6 poles + ⊕	122
CCE	6 poles + ⊕	130
CSS	6 poles + ⊕	148
CQE	10 poles + ⊕	168
MIXO	2 modules	262 - 317

hoods with 2 pegs



hoods with 2 pegs

M40 cable entry with 20 mm thread length



description	part No.	entry Pg	part No.	entry M	part No.	entry M
with pegs, side entry	CHO 06 L13	13,5	MHO 06 L20	20		
with pegs, side entry	CHO 06 L16	16	MHO 06 L25	25		
with pegs, side entry, high construction	CAO 06 L21	21	MAO 06 L25	25		
with pegs, side entry, high construction	CAO 06 L29	29	MAO 06 L32	32		
with pegs, side entry, high construction, without adapter ¹⁾	CFO 06 L21	21	MFO 06 L25	25		
with pegs, side entry, high construction, without adapter ¹⁾	CFO 06 L29	29	MFO 06 L32	32		
with pegs, side entry, high construction, without adapter ¹⁾					MFO 06 L40	40
with pegs, top entry ²⁾	CHV 06 L13	13,5	MHV 06 L20	20		
with pegs, top entry ²⁾	CHV 06 L16	16	MHV 06 L25	25		
with pegs, top entry, high construction	CAV 06 L21	21	MAV 06 L25	25		
with pegs, top entry, high construction	CAV 06 L29	29	MAV 06 L32	32		
with pegs, top entry, high construction, without adapter ¹⁾	CFV 06 L21	21	MFV 06 L25	25		
with pegs, top entry, high construction, without adapter ¹⁾	CFV 06 L29	29	MFV 06 L32	32		
with pegs, top entry, high construction, without adapter ¹⁾					MFV 06 L40	40

¹⁾ enclosure without adapter, threaded on the body, to be used only with a complete cable gland.

²⁾ cannot be used with MIXO series.

IP degrees are according to the type of lever of the counterpart enclosures.

Alternatively, hoods with pegs may be coupled with fixed enclosures:

- C-TYPE, IP65 or IP66/IP69 stainless steel lever, from page 387 to page 391
- C7, IP66/IP67/IP69 stainless steel lever, page 436
- CV, IP65 or IP66/IP69 stainless steel lever, page 444 and 445

CHO L (CAO L) and (CFO L) MHO L (MAO L) and (MFO L)

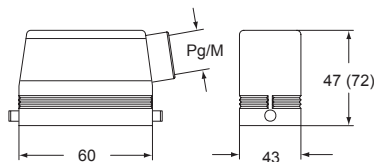

CHV L (CAV L) and [CFV L] MHV L (MAV L) and [MFV L]

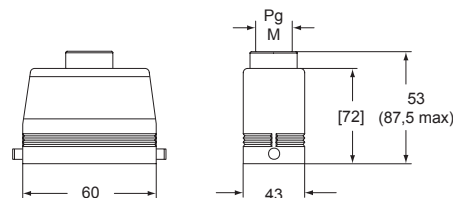

MFO 06 L40

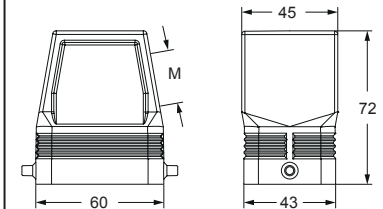

MFV 06 L40

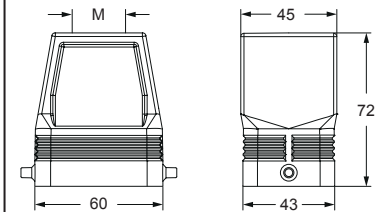

CALUS® Type 4/4X/12

insulating cable gland or fittings without gasket

cable gland with O-Ring gasket
IP67 if hoods without adapters coupled with IP67 housings