

REVISIONS			
REV.	DESCRIPTION	DATE	APPROVED
A	INITIAL RELEASE IN SW	3/23/2005	BEM

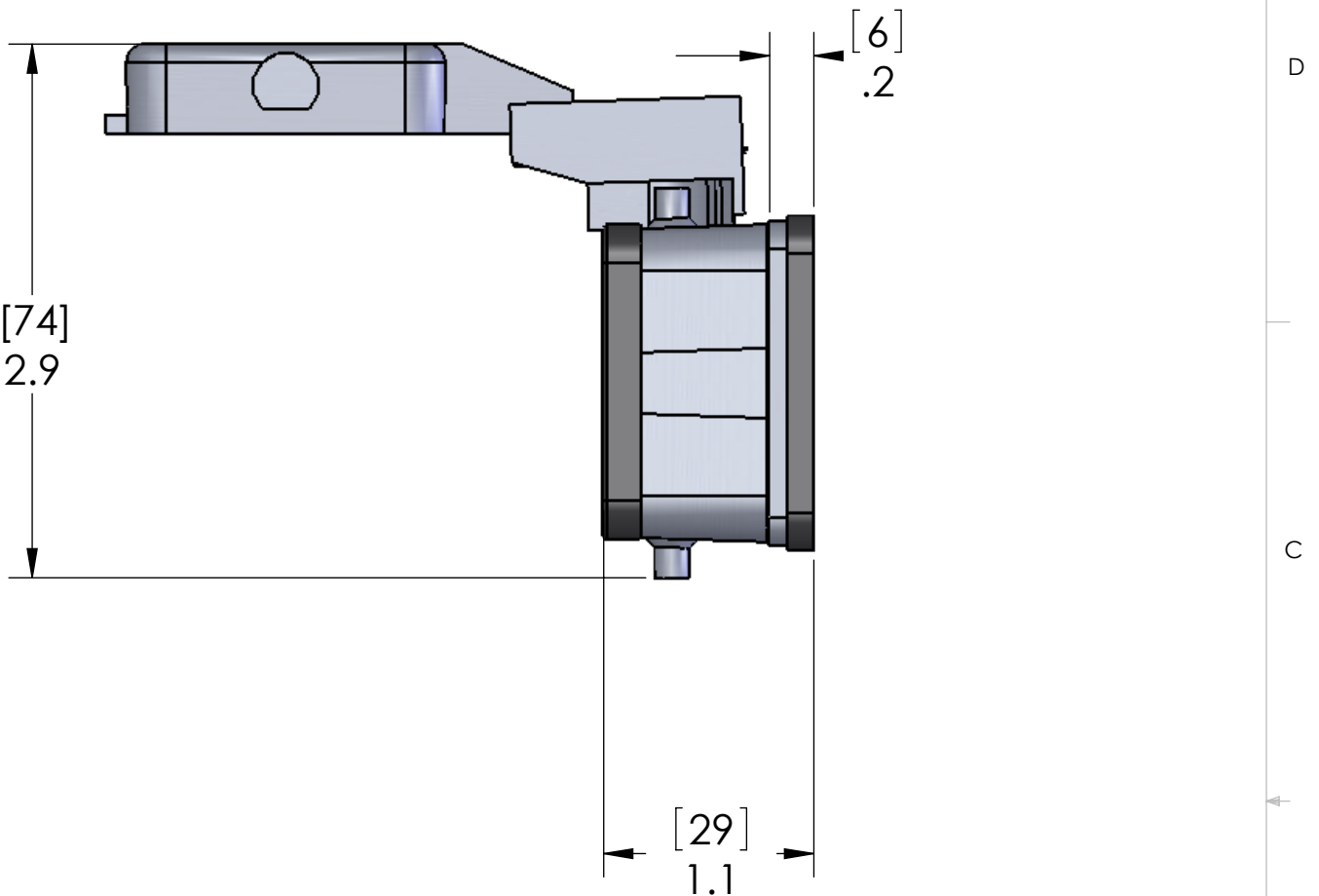

NOTE: THIS BASE ONLY MATES WITH HOODS WITH A LEVER AND **NO** GASKET (MUST HAVE "X" IN P/N: e.g. CAO-24X29)

HOUSING MATERIALS	
BODY:	EPOXY COATED DIE CAST ALUMINUM
GASKET:	THERMOPLASTIC ELASTOMER

UNLESS OTHERWISE SPECIFIED: DIMENSIONS ARE IN INCHES		NAME CAM	MENCOM CORPORATION	
	DRAWN		TITLE: 24 POL BASE 4 PEGS & COVER	
	CHECKED			
	ENG APPR.			
	MFG APPR.			
	Q.A.			
MATERIAL	COMMENTS:		SIZE	DWG. NO.
FINISH			<b>B</b>	CHI-24CS
DO NOT SCALE DRAWING		SCALE: 1:1	WEIGHT:	SHEET 1 OF 1

**PROPRIETARY AND CONFIDENTIAL**  
THE INFORMATION CONTAINED IN THIS DRAWING IS THE SOLE PROPERTY OF MENCOM CORPORATION. ANY REPRODUCTION IN PART OR AS A WHOLE WITHOUT THE WRITTEN PERMISSION OF MENCOM CORPORATION IS PROHIBITED.