

insert joining block



metal replacement handles



description

part No.

part No.

made of die cast aluminium alloy
to mate two inserts (see below)
to replace thermoplastic handles
2 component kit for dual lever enclosures ¹⁾

CBGF

CR TM-1

¹⁾ can only be used on dual lever enclosures
sizes 57.27, 77.27 and 104.27

CBGF combination block

- Allows two "44.27 size" inserts to be inserted in "104.27 size" enclosures and on the following COB series items: COB TCQ, COB 24 BC, COB TSF, COB TSFS, COB 24 CMS
- Allows female inserts and male inserts in the same enclosure or mounting
- Allows mixed type inserts in the same enclosure or mounting (for example, 6 poles 16A CNEF + 24 poles 10A CDDF)

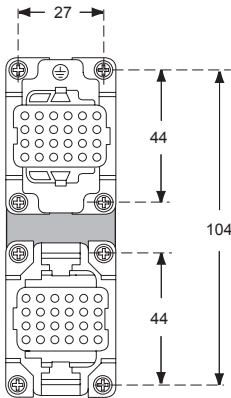
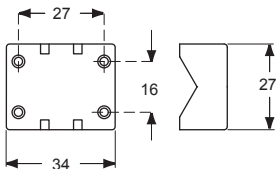
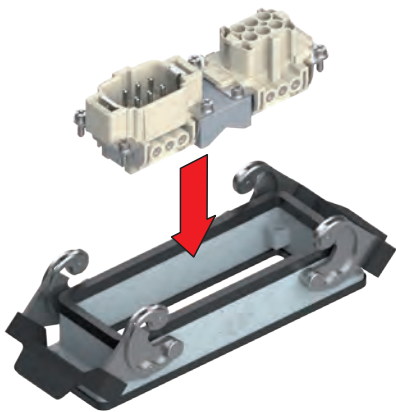

NOTE
Inserts shown in the drawing are just an example; any "44.27" sized inserts may be combined in a "104.27" housing, including of different gender.

C-TYPE enclosures:
size "104.27" from page 412

panel supports:
COB page 652 - 653

C-TYPE enclosures (with two levers only):
size "57.27" from page 393
size "77.27" from page 402
size "104.27" from page 412