

CA and MA CENTRAL LEVER

inserts		page:
CD	40 poles + ⊕	70
CDD	72 poles + ⊕	79
CDS	27 poles + ⊕	-
CDSH	27 poles + ⊕	88
CNE	16 poles + ⊕	112
CSE	16 poles + ⊕	-
CSH	16 poles + ⊕	112
CSH S	16 poles + ⊕	124
CCE	16 poles + ⊕	132
CMSH, CMCE	6+2 (aux) poles + ⊕	138 - 139
CSS	16 poles + ⊕	150
CQE	32 poles + ⊕	170
CQEE	40 poles + ⊕	176
CP	6 poles + ⊕	178
CX	6/12, 6/36 and 12/2 poles + ⊕	197 - 199
CX	4/0 and 4/2 poles + ⊕	200 - 201
MIXO	4 modules	262 - 317

hoods with central lever



hoods with central lever



description	part No.	entry Pg	part No.	entry M	part No.	entry Pg	part No.	entry M
side entry, high construction	CAO 16 YX21	21	MAO 16 YX32	32				
side entry, high construction	CAO 16 YX29	29	MAO 16 YX40	40				
top entry, high construction					CAV 16 YX21	21	MAV 16 YX32	32
top entry, high construction					CAV 16 YX29	29	MAV 16 YX40	40

Even when coding is not required, it is recommended to use CRM and CRF pins with CD and CDD inserts and CRM CX and CRF CX pins with MIXO inserts to reduce movements when fitting and removing the connectors and to avoid contact damages.

Within this scope, the DIN 43 652 standard requires a maximum angular longitudinal fluctuation of $\pm 5^\circ$.

CAO..YX and MAO..YX

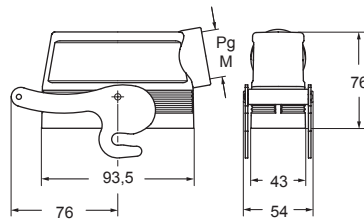

CAV..YX and MAV..YX

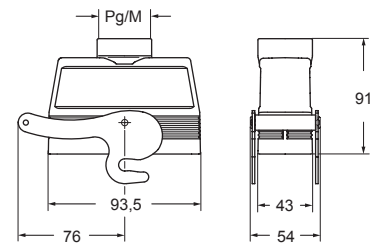

CAUS® Type 4/4X/12

