

ProControl™ PV3 & PV10 Series Inline Body Type

Humphrey®

Installation & Handling Instructions

INSTALLATION

- Valve is designed to operate with pressurized gas media piped to Inlet port, labeled 1 on valve body. Outlet port is labeled 2.
- Port thread for option P: 10-32 UNF
- Port thread for option EP: M5x0.8
- Using clean compressed air, blow out fittings and tubing, removing any chips or debris, which can cause valve malfunction or failure.
- Fittings are not included. Follow fitting manufacturer's installation and torque specifications to ensure appropriate connection.
- Valve may be mounted in any orientation. Secure valve to equipment using valve's mounting holes. Mounting hole pattern relative to piping port surfaces is shown in drawing at right.
- When mounting to equipment, do not tamper with valve's Lockring or Coil Housing.
- Terminate lead wires appropriately. Valve is polarity neutral.

HANDLING

- Do not adjust (loosen, tighten) Lockring or screwdriver slot of the Pole Piece. See drawing. Otherwise, valve will malfunction.
- Do not handle (carry) valve using its lead wires. Do not pull lead wires excessively. Otherwise, valve may malfunction, or fail to operate.
- Valve will function using vacuum as media. For best results with vacuum, connect source to outlet port (2). Consult factory for details.

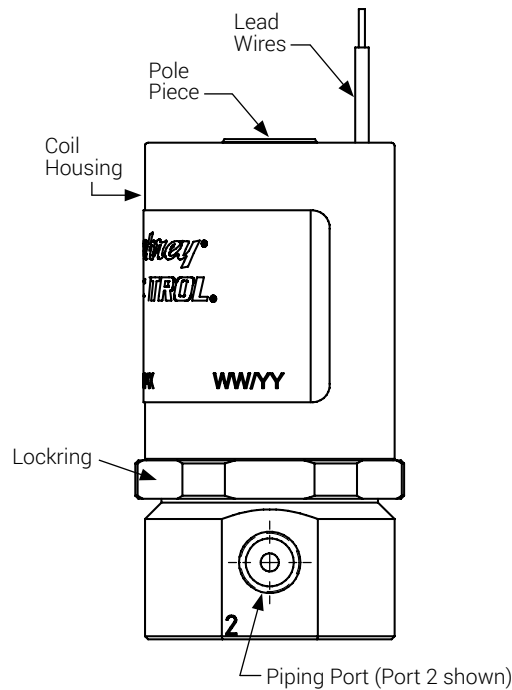

MOUNTING HOLE PATTERN

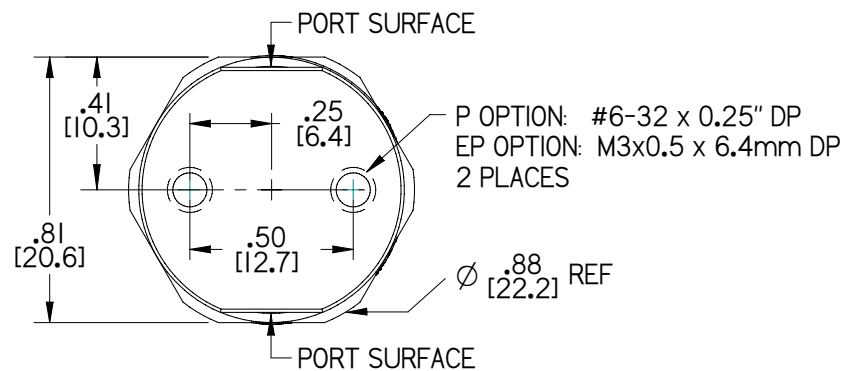

HUMPHREY-PRODUCTS.COM

A privately owned US company since 1901.
© 2022 Humphrey Products Company, Inc.
Printed in USA.

IHIPCV22

Humphrey Products Company
5070 East N Avenue
Kalamazoo, MI 49048 USA
P: 269.381.5500
F: 269.381.4113



ACCESS ONLINE CATALOG

Obtain 3D CAD Download, CAD Viewer,
2D Dimensional Drawings, Product Images,
DataSheet PDFs, Product Accessories

Certified: ISO 9001:2015